



17 Jugiong Street West Pymble NSW

4 1 2

Backing on to Lane Cove National Park and set on 1271 sqm at the end of a quiet cul-de-sac, this unique single level home was designed in the 1960's by award winning architects Robertson & Hindmarsh. With a flexible floorplan, a north to rear aspect and panoramic bush views, the home is comfortable as is, yet presents an outstanding opportunity to extend or rebuild (STCA). Set in a family friendly neighbourhood, it is within walking distance to West Pymble Public School, local village shops and buses to Gordon Station and Macquarie business park.

- Renovated gas kitchen with stone benchtops and breakfast bar
- Lounge/dining room with open fireplace, vaulted ceiling, bush views
- Four bedrooms with flexible floorplan allowing for an additional living area

Price : \$ 2,060,000
Land Size : 1271 sqm
View : <https://www.lorimerestateagents.com.au/sale/nsw/north-shore-upper/west-pymble/residential/house/7675011>



Matthew Lorimer
0400 844 411



Lee Duffy
0400 844 411

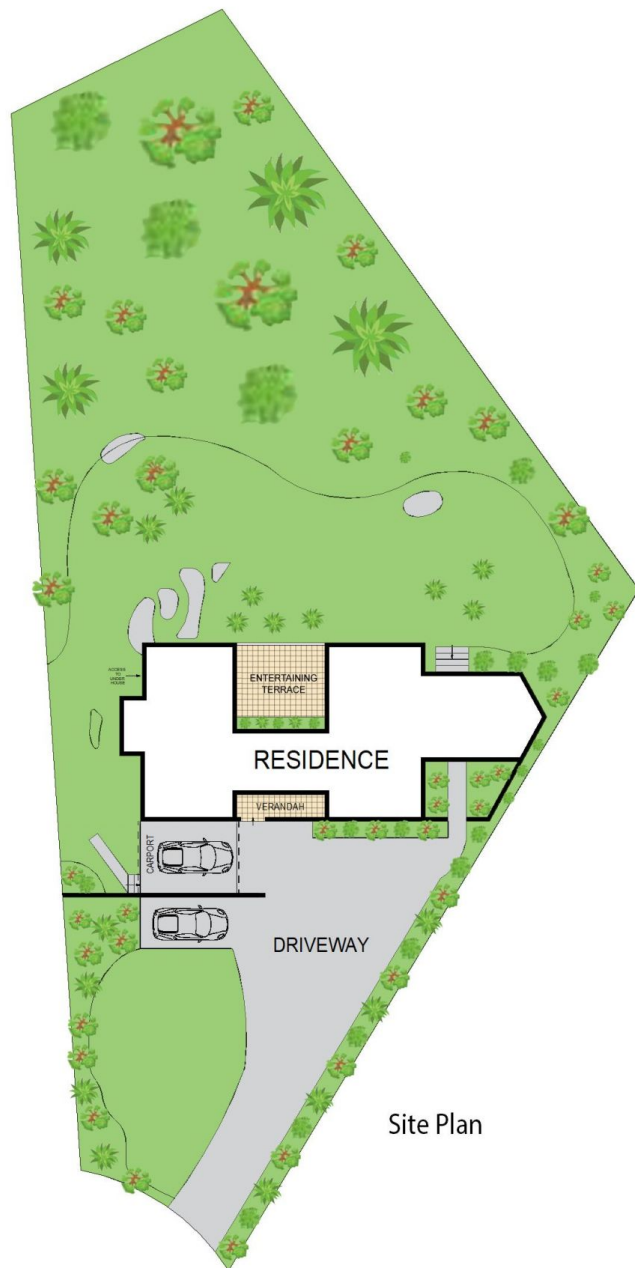

Site Plan

INTERNAL AREA APPROX : 110m²

17 Jugiong Street, West Pymble

Measurements are approximate, Floor plan is indicative only, Floor plan for marketing purposes only