



20 Arundel Street West Pymble NSW

4 3 2

Located at the end of a quiet cul-de-sac and enjoying views over Lane Cove National Park, this brick family home provides an enviable lifestyle. The open plan layout features multiple living zones to accommodate growing families and flows to a covered terrace overlooking the pool and level lawns with an ideal northerly aspect. Recently renovated interiors showcase an entertainer's gas kitchen, fully tiled bathrooms and polished timber floors. Set in a sought after neighbourhood, the home is within walking distance to West Pymble Public School, village shops and buses to Gordon station.

- Generous living, dining with gas fire opens to covered terrace
- Vast open plan gas kitchen flows to family room and terrace
- Three bedrooms with built ins, master with walk in and

Price : \$ 3,605,000
Land Size : 1499 sqm
View : <https://www.lorimerestateagents.com.au/sale/nsw/north-shore-upper/west-pymble/residential/house/6835426>



Matthew Lorimer
0400 844 411



Lee Duffy
0400 844 411

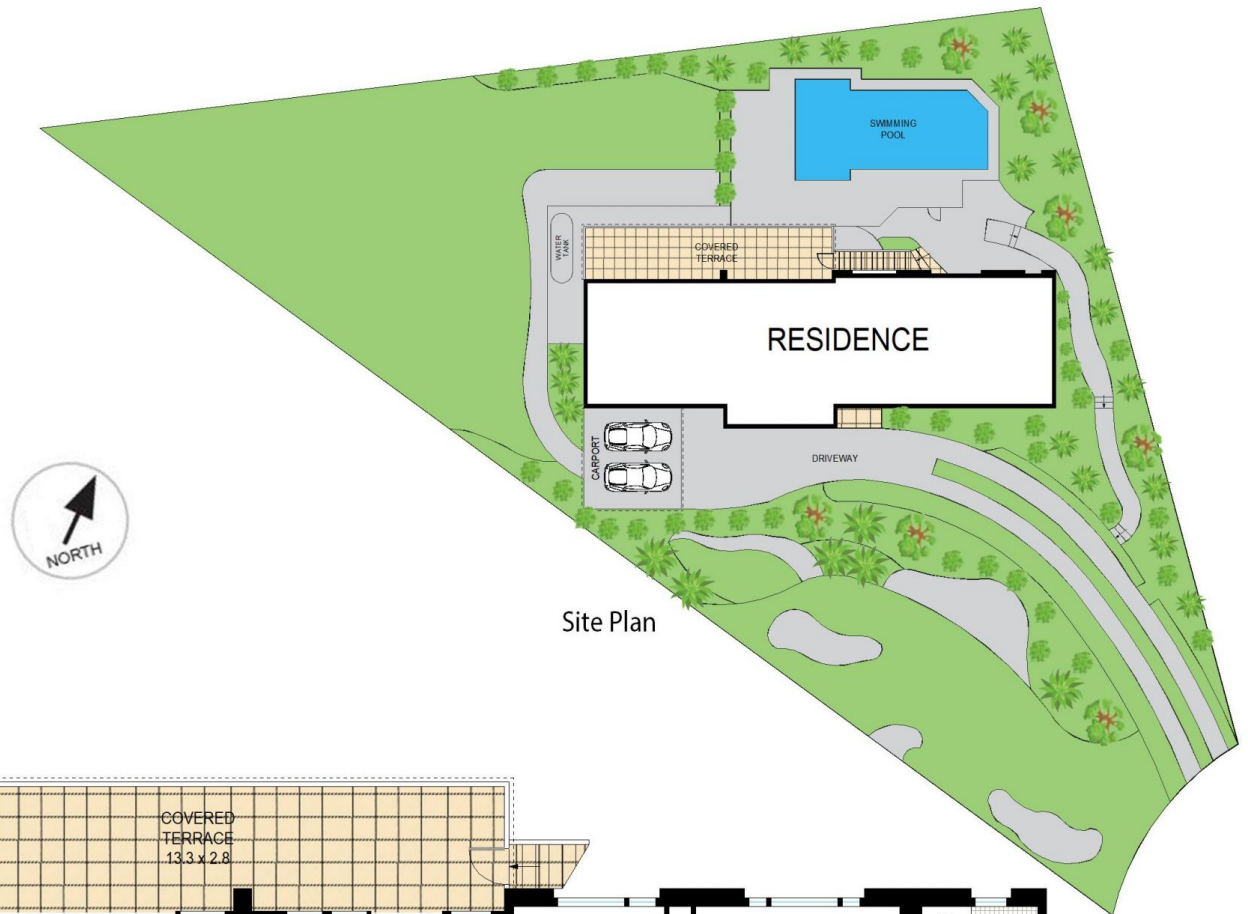

20 Arundel Street, West Pymble

Measurements are approximate, Floor plan is indicative only, Floor plan for marketing purposes only