



6 Coventry Place West Pymble NSW

4 2 2

Positioned in a small cul-de-sac in a family-friendly neighbourhood, this smartly presented residence delivers comfort, space and privacy on a large block that backs directly onto Avondale Golf Course. Its light filled floorplan is well appointed throughout and offers a generous layout that's great for entertaining. Buyers will also enjoy a private and spacious lifestyle without compromising on convenience as it offers good access to local shops, schools and parklands with excellent public transport servicing the area.

- A spacious design featuring separate formal and casual spaces
- Four double bedrooms include a master with built-ins and ensuite
- Expansive Vergola-covered patio that flows off the living area

Price : \$ 1,615,000
Land Size : 930 sqm
View : <https://www.lorimerestateagents.com.au/sale/nsw/north-shore-upper/west-pymble/residential/house/5671596>



Matthew Lorimer
0400 844 411



Lee Duffy
0400 844 411



GROUND FLOOR

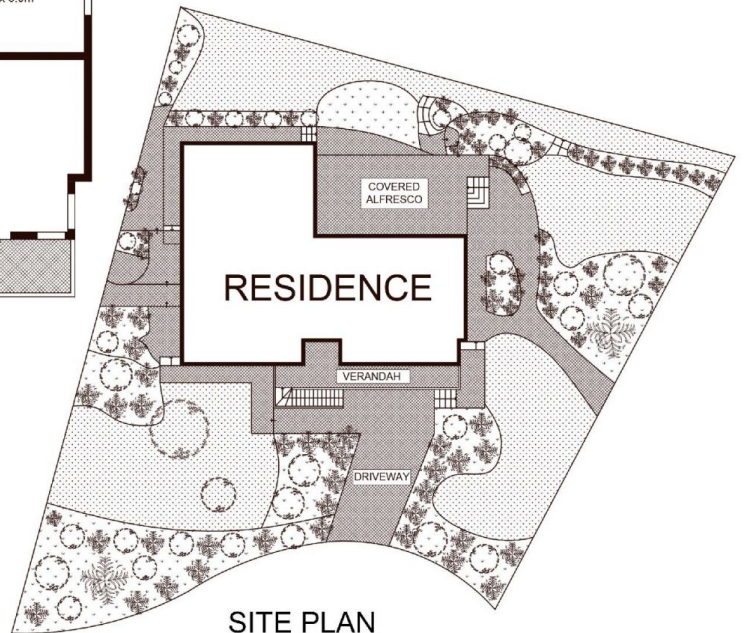

SITE PLAN

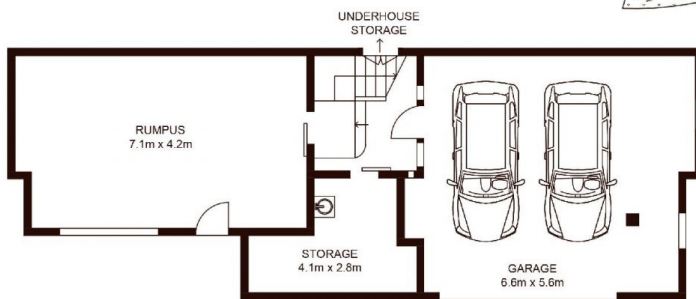

LOWER GROUND FLOOR

6 Coventry Place, WEST PYMBLE

Not to scale • All measurements are approximate • Drawn for marketing purposes only • Floorplan by © Industrie Media

